

MVHF-3P-NO

MECHANICAL VALVES

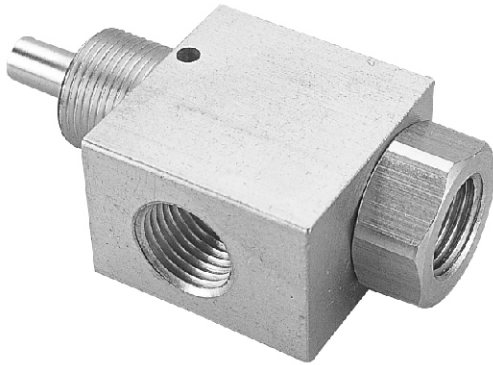

Specification:

| | |
|----------------------------|--|
| Type | normally OPEN 3-way poppet |
| Medium | Air |
| Stem travel | 1/8" |
| Input pressure | 150 psig max. |
| Effective orifice | 5.7 mm ² |
| Force for full stem travel | 38 oz. nominal |
| Temperature range | 32°F ~ 230°F |
| Ports | Input: 1/8" BSP Output: 1/8" BSP |
| Exhaust | Hole to atmosphere |
| Mounting | 15/32-32 male thread nuts and lock washers furnished |
| Weight | 69 g |

※ Port thread NPT. are also available.

