

# MSP-\*\*A/B series

**Hydraulic Work Support** Threaded-body type and flange type



## Description:

Hydraulic work support is used for avoiding deformation and decreasing vibration during machining.

## Types:

A type: knocking-out with a spring; the spring is used to control a contact force when the knocking out rod (piston rod) extends to a highest knocking-out position and contacts the workpiece.

B type: Knocking-out with oil pressure; with the knocking-out rod is at a lowest position, it is operated by means of oil pressure and is knocked out when being filled with oil and uses a spring to control the contact force with the workpiece.

**MSP-16A**

**MSP-16B**

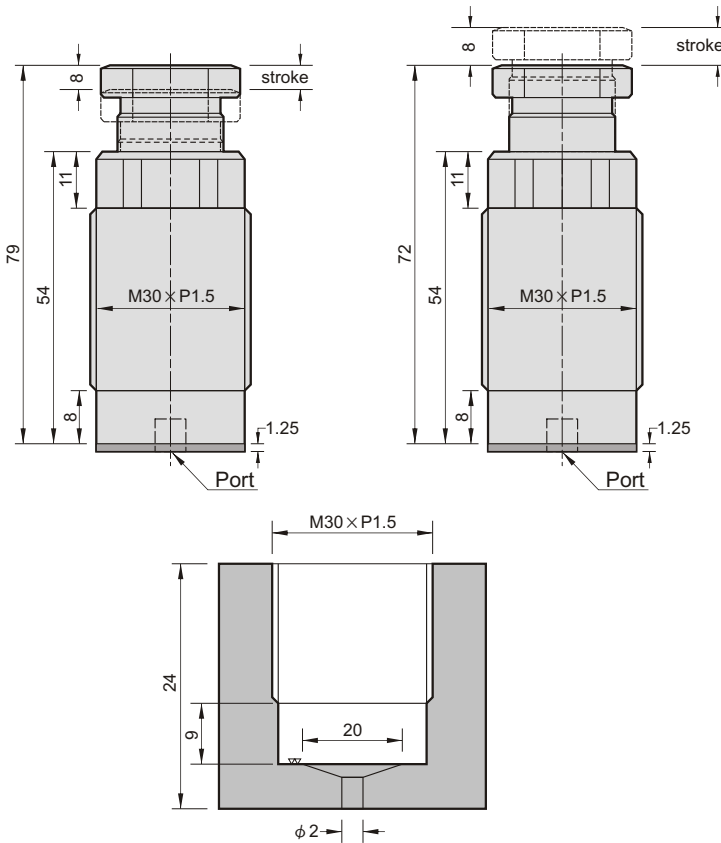

**MSP-30A**

**MSPT-30A**

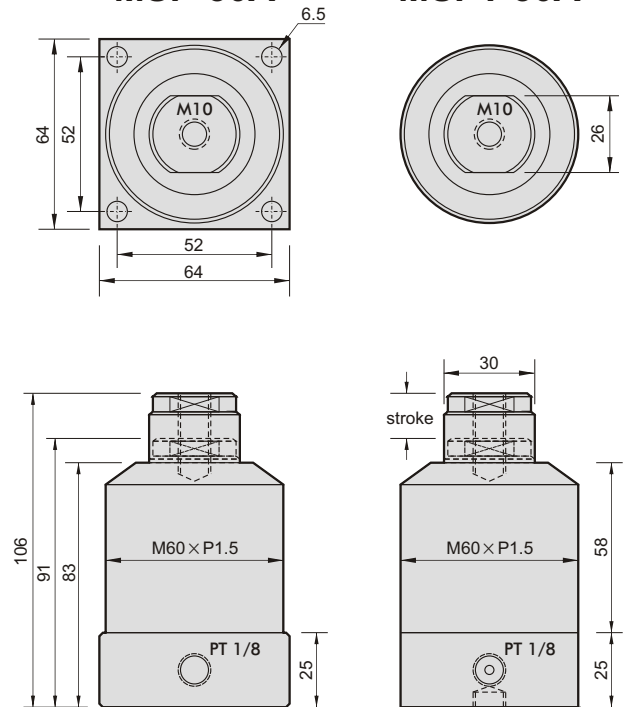

**Mounting diagram**

Item	Model	MSP-16A	MSP-16B	MSP-30A	MSPT-30A
Normal operating pressure		100-350 kg/cm <sup>2</sup>		75-350 kg/cm <sup>2</sup>	
Cylinder operating		Single-acting			
Piston-φ (mm)		16		30	
Stroke (mm)		8		15	
Theoretical force (200 kg/cm <sup>2</sup> )		210 kg		750 kg	