

Blank Finger

 Finger blank specifically designed for K type finger

Features

- Accurate centering is realized by the R combination of the finger blank and the master fingers.
- Use the finger blank by forming it according to the shape of your work.
- Remove the work stopper when it is not necessary.
- Nitriding proves effective if the wear of the fingers is to be prevented.

*Finger material: SF20T (Cr19~21%, Mo5~2.5%)

CHM

Blank Finger

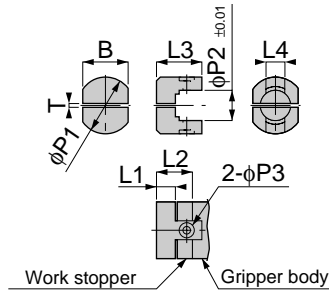

Unit : mm

Type	B	L1	L2	L3	L4	T	φP1	φP2	φP3	Mounting screw (provided)	Applicable Gripper	Mass (g)
CHM 08AK11	6	5	8	11.5	5	1	15	10	2.1	Hex Socket Head Cap Screws M2×4/ 2pieces	CHM 08A□K Type	4
CHM 08AK12		10	13	16.5								7
CHM 08AK13	12	5	8	11.5								6.5
CHM 08AK14		10	13	16.5								12
CHM 08AK15	16	5	8	11.5								11.5
CHM 08AK16		10	13	16.5								22
CHM 11AK11	8	6	10	14.5	7	2	20	13	Hex Socket Head Cap Screws M2.5×5/ 2pieces	CHM 11A□K Type	8	
CHM 11AK12	12	16	20.5	14.5								
CHM 11AK13	16	6	10	14.5							12.5	
CHM 11AK14		12	16	20.5							24	



1

CHM

Slotless Solid Blank

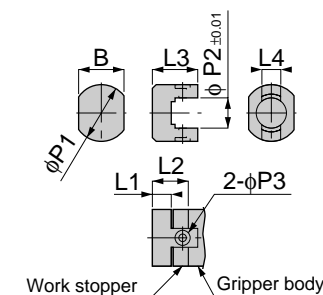
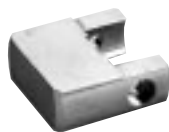

Unit : mm

Type	B	L1	L2	L3	L4	φP1	φP2	φP3	Mounting screw (provided)	Applicable Gripper	Mass (g)
CHM 08AK01	6	5	8	11.5	5	15	10	2.1	Hex Socket Head Cap Screws M2×4/ 2pieces	CHM 08A□K Type	4.5
CHM 08AK02		10	13	16.5							7.5
CHM 08AK03	12	5	8	11.5							7
CHM 08AK04		10	13	16.5							13
CHM 08AK05	16	5	8	11.5							12.5
CHM 08AK06		10	13	16.5							23
CHM 11AK01	8	6	10	14.5	7	20	13	2.6	Hex Socket Head Cap Screws M2.5×5/ 2pieces	CHM 11A□K Type	8.5
CHM 11AK02	12	16	20.5	16							
CHM 11AK03	16	6	10	14.5							14
CHM 11AK04		12	16	20.5							29



1